

! WARNING! DEATH or SERIOUS INJURY can occur if manufacturer's instructions are not followed correctly.

E-Z-ON[®] Model #543 KidCam[™] *for School Buses*

- Use on a school bus seat only
- Meets FMVSS213.
- Use for a passenger weighing 30-80 lbs.
- You **must** use this KidCam[™] restraint with a school bus lap belt.
- **Replace** after a crash or 5 years from the date of manufacture.
- Crotch straps are **not** needed when used with a booster.
- **Be sure** to register this restraint to be notified of a safety recall.
- **Passengers seated behind occupants in KidCam[™] must be restrained with a seatbelt or other restraint, or the seat be unoccupied.**



E-Z-ON[®]
Products, Inc. of Florida

605 Commerce Way West • Jupiter, FL 33458

800-323-6598/561-747-6920 • Fax 561-747-8779 • www.ezonpro.com

© 2005 E-Z-ON[®]

E-Z-ON® Model #543 KidCam™ for School Buses Installation Guide for School Buses

Bus seats must have seatbelts and access between the seat cushion and seat back to install.

Step 1

Attaching the KidCam™ to the school bus seat for passengers weighing 30-80 lbs.

1. **Unlock** the bus seat and lift up.
2. **Place** the Y-bridge on the seat top ;
 - a. **rest** black shoulder straps on the front of the bus seat,
 - b. **allow** crotch straps to pass through the seat opening to rest on the bus seat. **Close and lock** the bus seat.
3. **Wrap** the gray cam strap around the bus seat:
 - a. **lower** the o-bracket over the back of the bus seat,
 - b. **pass** the snap hook through the front seat opening.
4. **Attach** the snap hook onto the o-bracket.
5. **Secure** the gray cam strap:
 - a. **press** the spring lock,
 - b. **pull** gray webbing end snug,
 - c. **create** a crease on top of the bus seat.

2
front of
bus seat

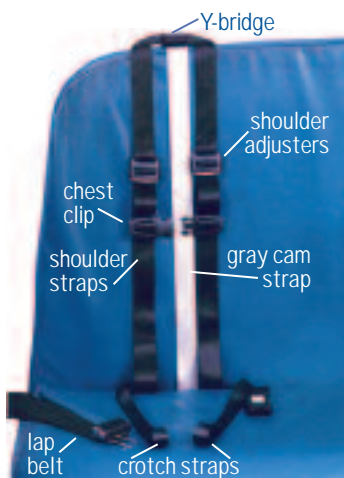

3

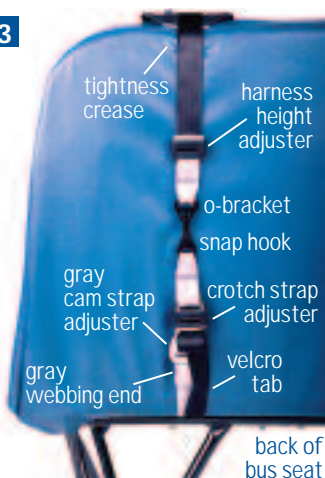

4

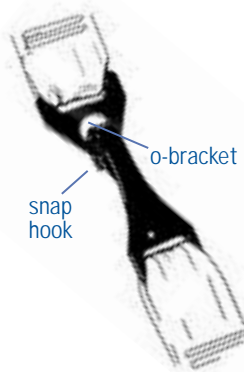

5

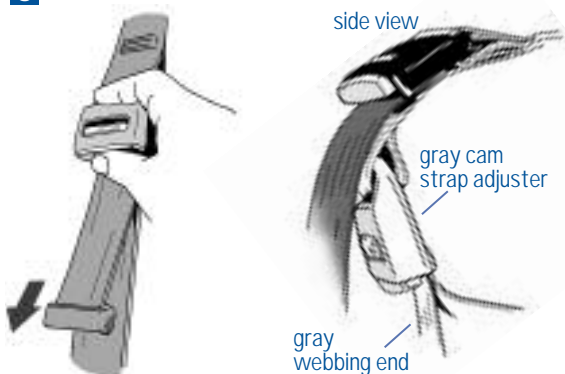

Step 2

Securing the Passenger:

Be sure the passenger sits upright with buttocks against the seat back.

1. Place harness straps over each shoulder.
2. Locate the crotch straps in the center of the passenger's legs.
3. 1st thread lap belt through the 1st crotch loop, 2nd through the 1st harness loop, 3rd through the last harness loop and 4th through the last crotch loop.
4. Buckle lap belt low across the lap. Reduce lap belt slack.
5. If using a booster no crotch straps are necessary according to NHTSA regulations. Thread lap belt through both harness loops and keep lap belt under booster arms. Reduce lap belt slack.

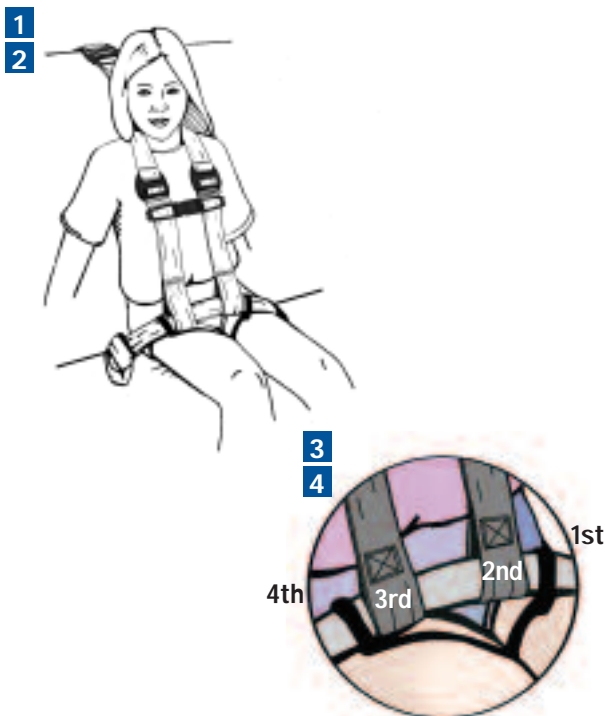

! WARNING! Failure to thread the crotch straps like this could cause injury.

Step 3

Adjusting the Harness Straps on the passenger:

1. To shorten harness straps: Press the spring-locks on each harness adjuster. Pull loose ends of webbing to shorten.
2. To lengthen harness straps: Press the spring-locks on each harness adjuster. Pull harness loop ends (lap belt is threaded through these) downward, to lengthen.
3. Keep both adjusters at the same height on the passenger.

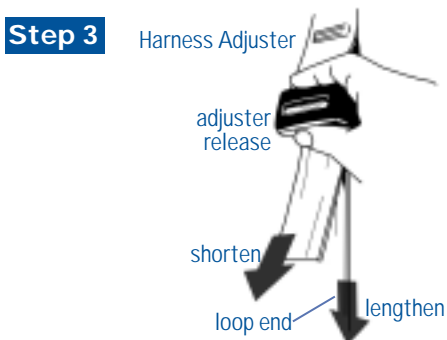

! WARNING! DO NOT shorten harness length to much. This could pull lap belt up, over stomach and cause injury. Harness should fit securely without slack. Some seat belts have long fixed (female) ends. NHTSA recommends 7.5 inch fixed belt ends for best fit. **A booster helps keep lap belt low when seat belt fixed ends are too long.**

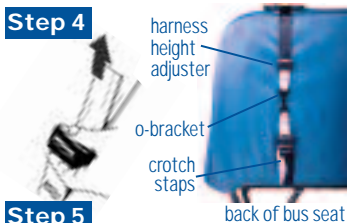
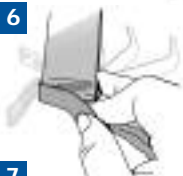
**Step 5****Step 6****Step 7****Step 4**

Adjusting the Harness Height Adjuster on passenger.
Keep both harness adjusters even on passenger.

1. **Adjust** harness height by sliding **Y-bridge** on gray cam strap.
2. **Harness height adjuster** is attached to gray cam strap above the o-bracket.
3. **Press** spring-lock on **height adjuster**:
 - a. **pull** black webbing end to shorten harness height,
 - b. **pull** harness to lengthen harness height.

Step 5

Adjusting the crotch straps

1. **Adjust** crotch straps snug but not too tight.
2. **Press** spring-lock on crotch strap adjuster:
 - a. **pull** black webbing end to shorten straps,
 - b. **pull** harness to lengthen straps.

Step 6

Adjusting velcro-tab

1. **Roll-up** webbing ends on the **height adjuster**, the **crotch strap adjuster** and the **cam adjuster**.
2. **Secure** the velcro-tab.

Step 7

Adjusting the chest clip

1. **Squeeze** male end to fit in the female end to secure.
 - a. **Squeeze** the male end to release.
 - b. **Keep** the clip below the harness adjusters at arm-pit level.

How to Register This Child Restraint

Child restraints could be recalled for safety reasons.

You **must** register this restraint in order to be notified of a recall.

Fill out the REGISTRATION CARD enclosed with your E-Z-ON® Harness, send your name address and the restraint model number and manufacturing date to the address below or **log on** to our website www.ezonpro.com and **fill out** your product information via our registration page.

For recall information, **call** the U.S. Government Auto Safety Hotline at 1 (800) 424-9393. In the Washington D.C. area call (202) 366-0123.



E-Z-ON®
Products, Inc. of Florida

605 Commerce Way West • Jupiter, FL 33458

800-323-6598/561-747-6920 • Fax 561-747-8779 • www.ezonpro.com

© 2005 E-Z-ON®